

proposal

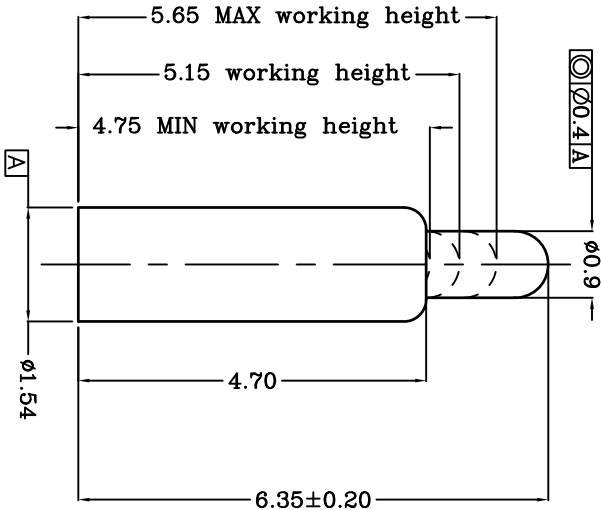

Table 1 Mechanical performance		
working height	5.15mm	100±20gf <2.1>
durability	10,000cycle	

- Notes
- 1 Dimensions shall be interpreted per ASME Y14.5M.
  - 2 Mechanical performance(See the table 1)
  - 3 The force is the average of forces obtained when plunger goes downwards and upwards.
  - 4 RoHS compliant.

Item	Part name	Q'ty/Ed	Material	Finish
1	Body	1	Leaded Brass	Au 0.1um plating Ni 1.4um
2	Plunger	1	Leaded Brass	Au 0.4um plating Ni 1.4um
3	Spring	1	Stainless steel wire	_____
4				
5				

Rev.	Revision record.	Date.	Top-Link Electronics Ltd.	Type	Customer drawing	Unit	mm	Weight	Part Number
3	total height is 6.35mm and working height is 4.70mm	2012/10/19	TOLERANCES UNLESS OTHERWISE SPECIFIED	DWN:	JERRY	APVD:			101672-1
2	total height is 6.25mm and working height is 4.60mm	2012/10/18	0.00 = ±0.15	CHK:	REL:				
1	NEW	2012/10/17	0.000 = ±0.10	Angle: ±4°					
			SURF. TEXTURE: REMOVE BURRS. BREAK SHARP EDGES R0.05 MAX.DD NOT SCALE PRINT.	Name	POGO PIN				
				Scale	1:1	Size	A4	DWG No.	C-101672
								Page	1/1
								Rev.	3